

RoHS

This products can apply to the HRS Doc NO.QA-3-04-005  
of Environmental&Material Management Rules

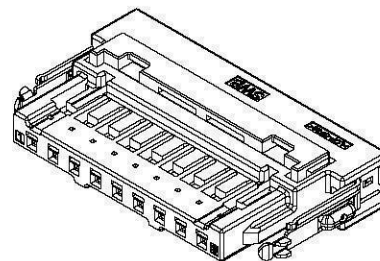
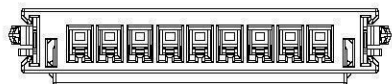

3D Views

## ■ Specifications:

- Voltage rating:125V Max.AC /DC
- Current rating:3A Max.AC/DC
- Withstanding voltage: 500V AC/minute
- Temperature range:-40 ~+125
- Insulation resistance: 100M
- Contact resistance: 20m
- After environmental testing: 25m
- Material(shackle):SUS
- Material(Housing):LCP
- Symbols for SPC dimensions: “ ”
- Product Specification:PS-HRS-2035-01
- Packaging:see HRS drawing PK-HRS-2035AM-XXX-LPBK

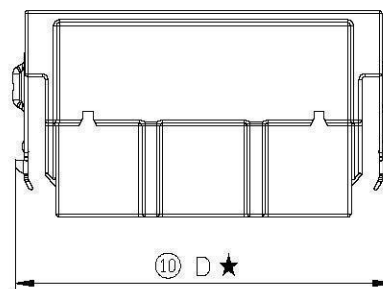
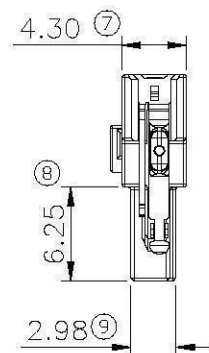
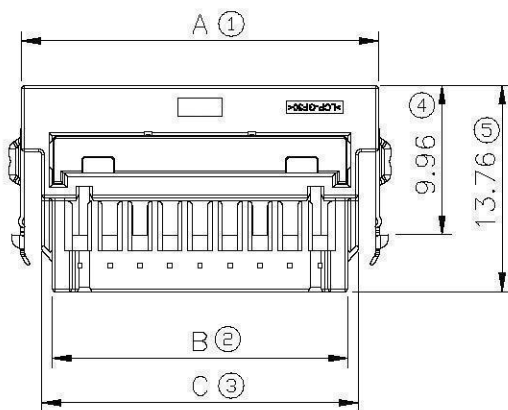

HRS-2035 A M-XX B X- LP BK  
① ② ③ ④ ⑤ ⑥ ⑦ ⑧

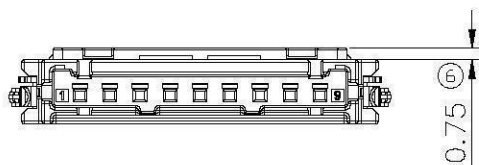

Size (mm)									
PIN	A	B	C	D	PIN	A	B	C	D
2	9.80	5.70	7.10	11.75	10	25.80	21.70	23.10	27.75
3	11.80	7.70	9.10	13.75	11	27.80	23.70	25.10	29.75
4	13.80	9.70	11.10	15.75	12	29.80	25.70	27.10	31.75
5	15.80	11.70	13.10	17.75	13	31.80	27.70	29.10	33.75
6	17.80	13.70	15.10	19.75	14	33.80	29.70	31.10	35.75
7	19.80	15.70	17.10	21.75	15	35.80	31.70	33.10	37.75
8	21.80	17.70	19.10	23.75	16	37.80	33.70	35.10	39.75
9	23.80	19.70	21.10	25.75					

- ① Series No:HRS-2035
- ② semi:A-HSG finished product of secondary lock
- ③ Category:M-Male
- ④ Row No.-Pin No:XX-single row2~16Pin
- ⑤ TYPE:B-TYPE B
- ⑥ Special No.:Blank-with HRS LOGO  
1-without LOGO
- ⑦ Plastic material:LP-LCP UL94V-0
- ⑧ Color:BK-Black

A

GENERAL TOLERANCE						Horus Int. Electronics. Co., LTD. HorusTech Electronics. Co., LTD.				PART NO. HRS-2035AM-XXBX-LPBK				
2022/5/15	A0	/	Added no Logo specifications	Sally Hu	Hong Zou									
2022/1/12	X1	/	Change of the part No	Sally Hu	JohnYang	.X ±0.35	APPROVAL				TITLE 2.00mm Male Connectors YPE B			
DATE	REV	ECN NO.	DESCRIPTION	MODIFY	APPROVAL	.XX ±0.25	CHECK				UNIT	SCALE	SHEET	REV
						.XXX±0.15	DRAWN				mm	1:1	1/1	A0
						X' ±2"	DATE							NUMBER
						PROJECT	Jack Zhang							CD
							Larry Yang							
							Sally Hu							
							2021/11/10							

RoHS

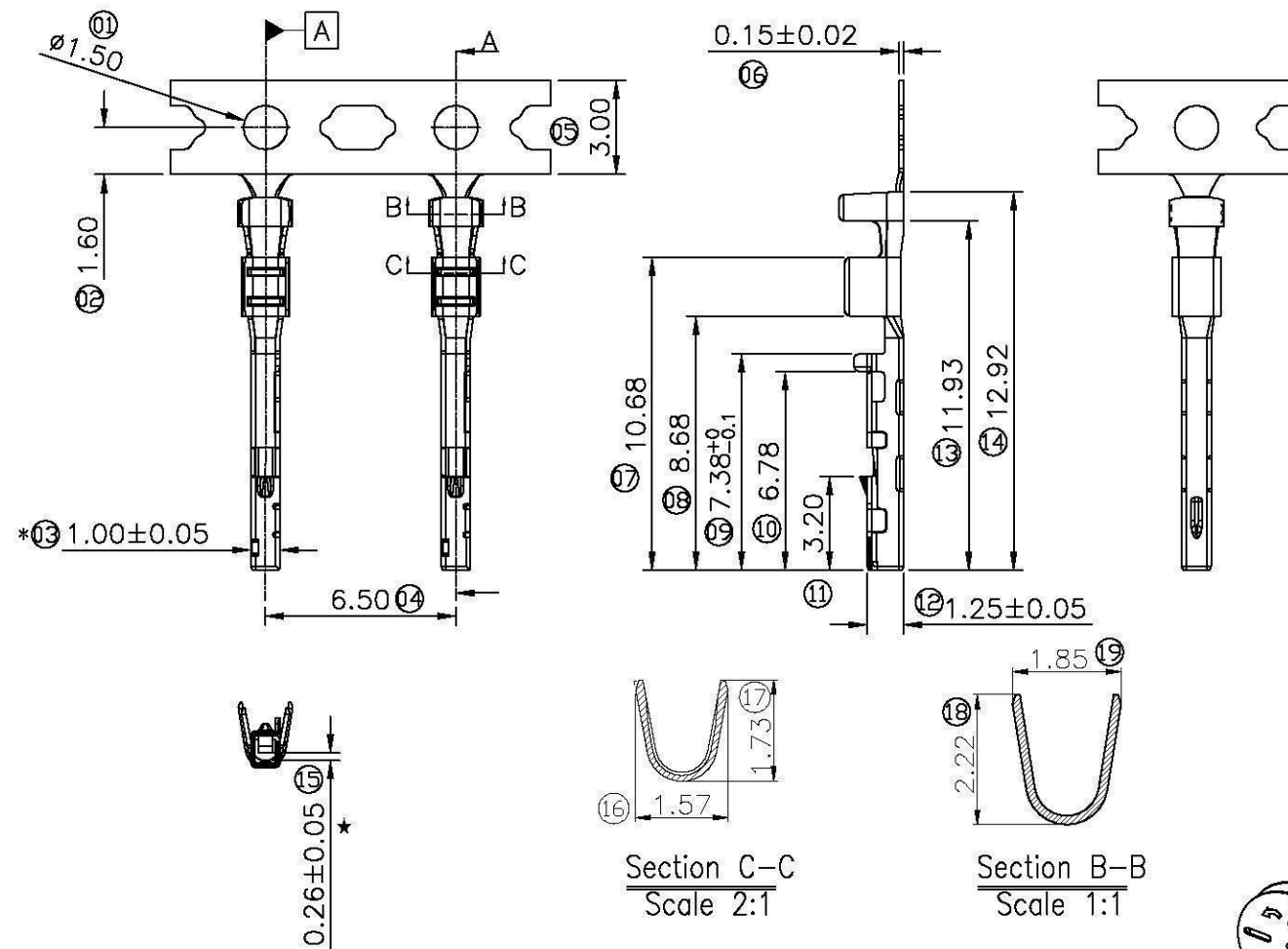
This products can apply to the HRS Doc NO.OA-3-04-005  
of Environmental&Material Management Rules

## ■ Specifications:

- Current Rating: 3A AC/DC (0.35mm<sup>2</sup> Wire)
- Temperature Range: -40 ~ +125
- Contact Resistance: 10m  
After environmental testing: 25m
- Mates With HRS Housing: HRS-2035AM-XXB
- Packaging Drawing: PK-HRS-2035T-HY2B-B
- Product Specification: PS-HRS-2035-01
- Symbols for SPC Dimensions:

HRS-2035 T -H Y2 B- B X  
① ② ③ ④ ⑤ ⑥ ⑦

- ① Series No.: HRS- 2035
- ② Category: T-Terminal
- ③ Material: H-High conductivity copper
- ④ Plating Code: Y2-40~120u " (1~3um) TIN
- ⑤ Plating Process: B-Stamping After Plating
- ⑥ TYPE: B-TYPE B
- ⑦ Special No.: Blank-with HRS LOGO  
1-without LOGO

HRS-2035T-HY2B-B	AWG#24~22 (0.22~0.35mm <sup>2</sup> )	$\phi 1.4$ mm Max
Part NO.	Wire Range	Insulation O.D.

						GENERAL TOLERANCE				PART NO.			
						.X $\pm 0.35$				HRS-2035T-HY2B-BX			
						.XX $\pm 0.25$				TITLE			
						.XXX $\pm 0.15$				2.00mm Crimp Terminal			
						X' $\pm 2^\circ$				UNIT			
						PROJECT				mm			
						APPROVAL				SCALE			
						CHECK				1:1			
						DRAWN				SHEET			
						DATE				REV			
						2021/05/07				NUMBER			
						Jack Zhang				A0			
						Larry Yang				CD			
						Yike Zhang							

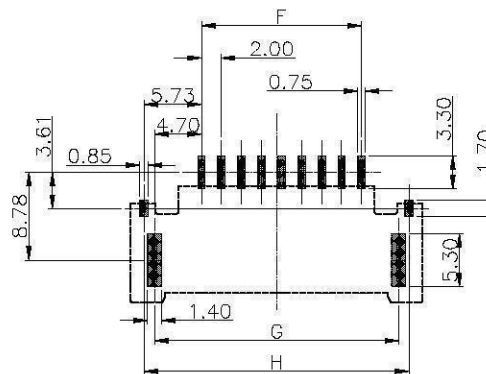
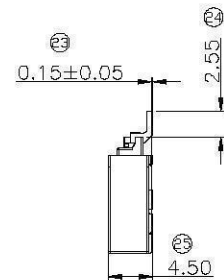
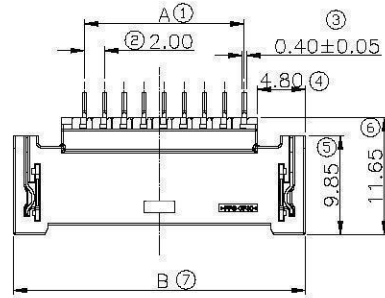

Recommended P.C.B LAYOUT  
General Tolerance $\pm 0.05$

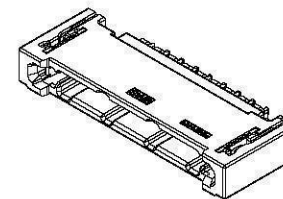
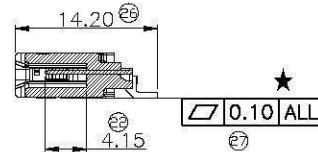
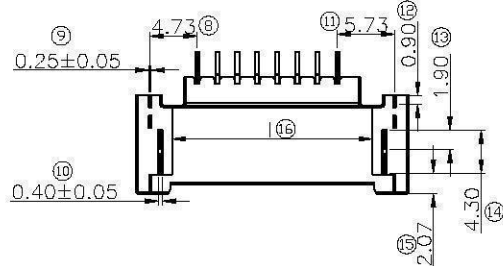
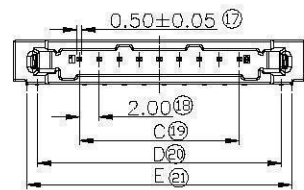

3D Views

#### Specifications:

- Voltage rating:125V Max.AC/DC
- Current rating: 3A Max.AC / DC
- Withstanding voltage: 500V AC/minute
- Temperature range:-40°C~+125°C
- Insulation resistance: 100M
- Contact resistance: 20m
- After environmental testing: 25m
- Material(Pin): Brass
- Material(BASE):PPS
- Plating Code: Underplate:  
Ni:1~3um Sn:2~5um
- Symbols for SPC dimensions:" "
- Product Specification:PS-HRS-2035-01
- Packaging:see HRS drawing PK-HRS-2035
- When mounting,Thickness of solder paste:0.15mm Min

HRS-2035 W R S - XX B X- PP SW1 B R  
① ② ③ ④ ⑤ ⑥ ⑦ ⑧ ⑨ ⑩ ⑪

- ① Series No:HRS-2035
- ② Category:W-wafer
- ③ Connector Type:R-Right Angle 90°
- ④ Mounting Type:S-SMT
- ⑤ Row No.-Pin No:XX-single row2~16Pin
- ⑥ TYPE:B-TYPE B
- ⑦ Special No.:Blank-with HRS LOGO  
1-without LOGO
- ⑧ Plastic material:PP-PPS UL94V-0
- ⑨ Plating Code:SW1-See note
- ⑩ Color:B-Black
- ⑪ Packing:R-Reel!

Size(mm)

PIN	A	B	C	D	E	F	G	H	I	PIN	A	B	C	D	E	F	G	H	I
2	2.00	15.20	2.00	10.40	12.46	2.00	10.40	12.46	8.00	10	18.00	31.20	18.00	26.40	28.46	18.00	26.40	28.46	24.00
3	4.00	17.20	4.00	12.40	14.46	4.00	12.40	14.46	10.00	11	20.00	33.20	20.00	28.40	30.46	20.00	28.40	30.46	26.00
4	6.00	19.20	6.00	14.40	16.46	6.00	14.40	16.46	12.00	12	22.00	35.20	22.00	30.40	32.46	22.00	30.40	32.46	28.00
5	8.00	21.20	8.00	16.40	18.46	8.00	16.40	18.46	14.00	13	24.00	37.20	24.00	32.40	34.46	24.00	32.40	34.46	30.00
6	10.00	23.20	10.00	18.40	20.46	10.00	18.40	20.46	16.00	14	26.00	39.20	26.00	34.40	36.46	26.00	34.40	36.46	32.00
7	12.00	25.20	12.00	20.40	22.46	12.00	20.40	22.46	18.00	15	28.00	41.20	28.00	36.40	38.46	28.00	36.40	38.46	34.00
8	14.00	27.20	14.00	22.40	24.46	14.00	22.40	24.46	20.00	16	30.00	43.20	30.00	38.40	40.46	30.00	38.40	40.46	36.00
9	16.00	29.20	16.00	24.40	26.46	16.00	24.40	26.46	22.00										

20220519	A2	/	Added thethe mounting thickness of solder paste	Sally Hu	Hong Zou	GENERAL TOLERANCE
20220422	A1	/	Added dimensions andd Update the PCB LAYOUT	Sally Hu	Hong Zou	.X $\pm 0.35$
20220411	A0	ER120220329001	Added specifications without Logo	Sally Hu	Hong Zou	.XX $\pm 0.25$
						.XXX $\pm 0.15$
						X.* $\pm 2$
						PROJECT
DATE	REV	ECN NO.	DESCRIPTION	MODIFY	APPROVAL	



Horus Int. Electronics. Co., LTD.  
Horustech Electronics. Co., LTD.

PART NO.  
HRS-2035WRS-XXBX-PPSW1BR

TITLE  
2.00mm Wafer Connectors TYPE B

UNIT	SCALE	SHEET	REV	NUMBER
mm	1:1	1/1	A2	CD

APPROVAL	CHECK	DRAWN	DATE
Jack Zhang	Larry Yang	Sally Hu	2021/11/10